



2.92mm-SMA adapters(DC~27GHz)

Specifications

Impedance: 50Ω
Frequency: DC-27GHz
Durability: 500 cycles
Temperature Range: -55°C~+165°C

Material/Finishing

Housing: Stainless Steel SU303	Polished/Passivated
Center contact: Beryllium Copper	Gold plated(MIL-G-45204)
Insulators: PEI	

2.92mm/SMA interfaces PER MIL-STD-348A

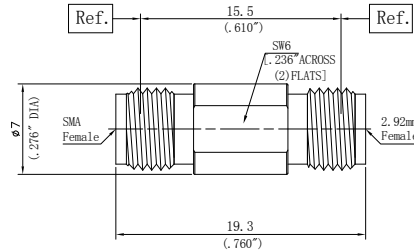

Description	2.92mm (f) to SMA (f)
PN	Z365500Z01
VSWR	DC-27GHz...1.15:1 (max)

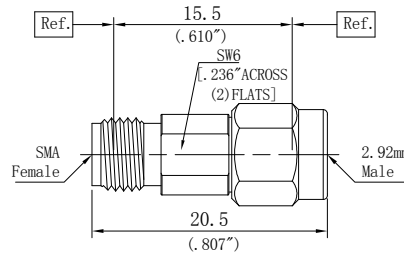

Description	2.92mm (m) to SMA (f)
PN	Z365510Z01
VSWR	DC-27GHz...1.15:1 (max)

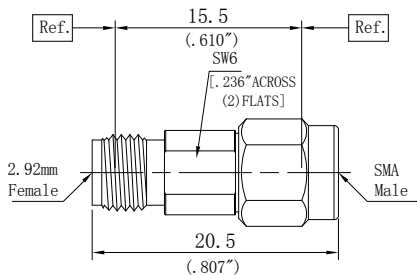

Description	2.92mm (f) to SMA (m)
PN	Z365501Z01
VSWR	DC-27GHz...1.15:1 (max)

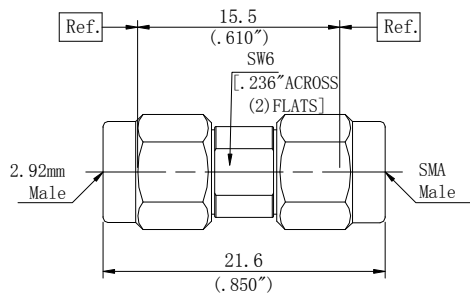

Description	2.92mm (m) to SMA (m)
PN	Z365511Z01
VSWR	DC-27GHz...1.15:1 (max)